

D

C

B

A

D

C

B

A

8

7

6

5

4

3

2

1

	REVISIONS			
REV	DESCRIPTION		DATE	APPROVED
A1	9.0	was 9.5	11/05/08	R. Smith
A2	.31	was .4		
A3	1.69	was .100		
B1	9.58	was 9.45	04/13/09	RJ Ponchione
B2	17.50	was 18.45		
B3	2X 0.31	Removed		
B4	2X 2.00	was 2X 1.69		

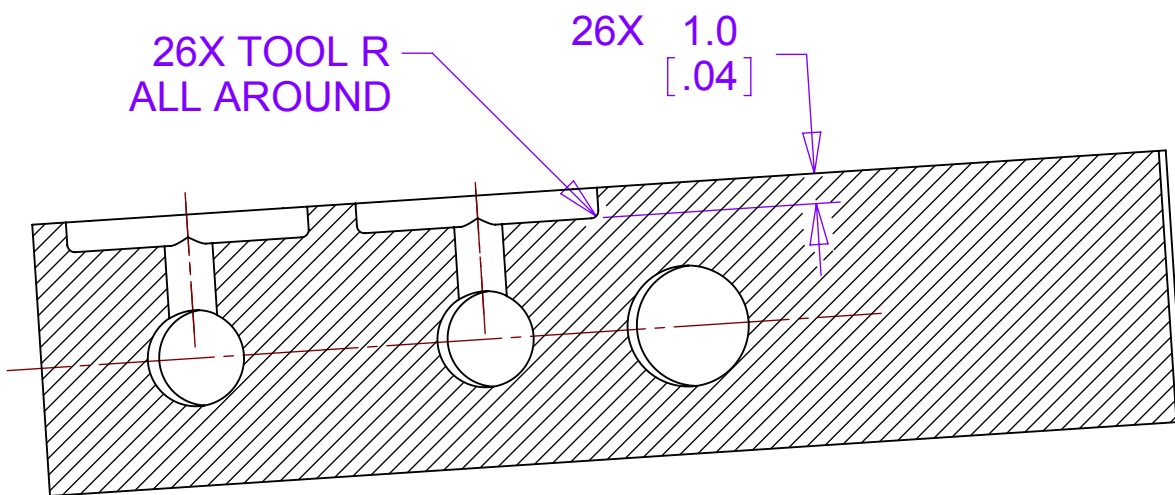
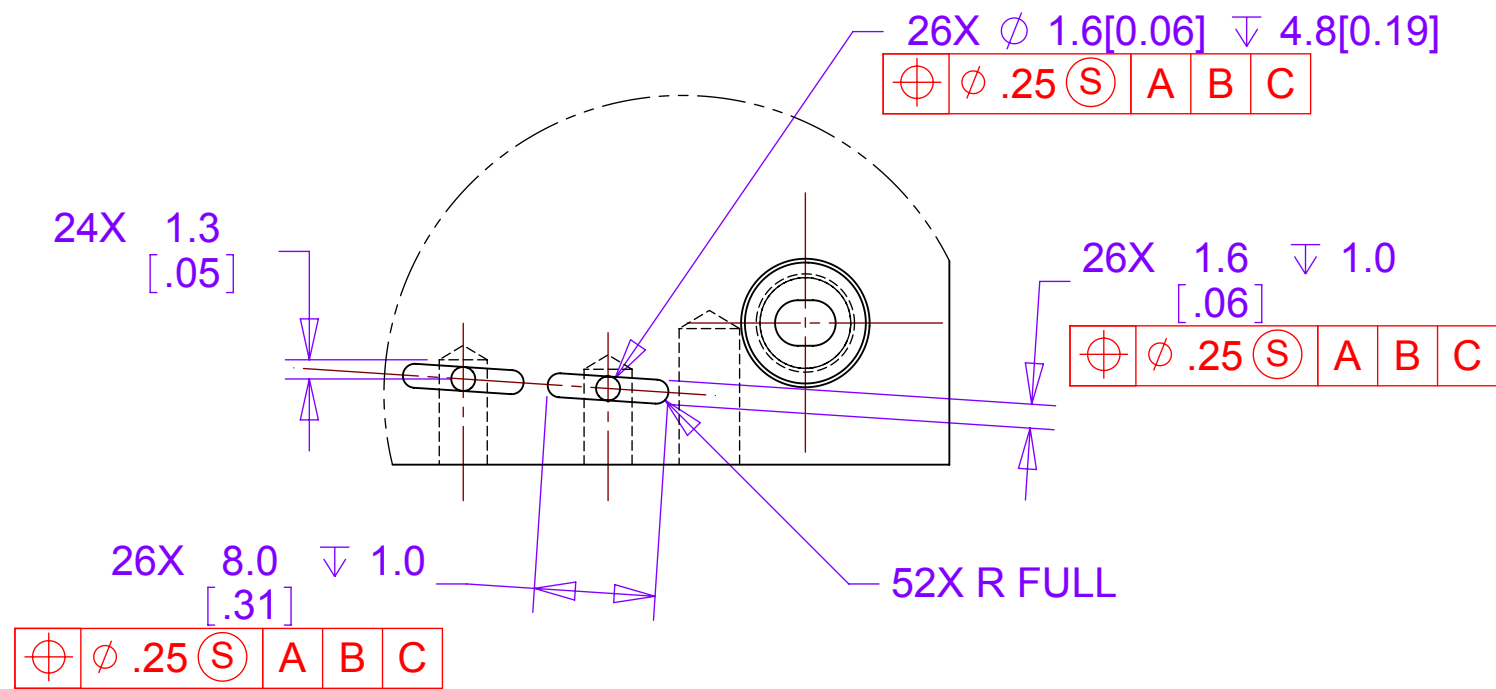
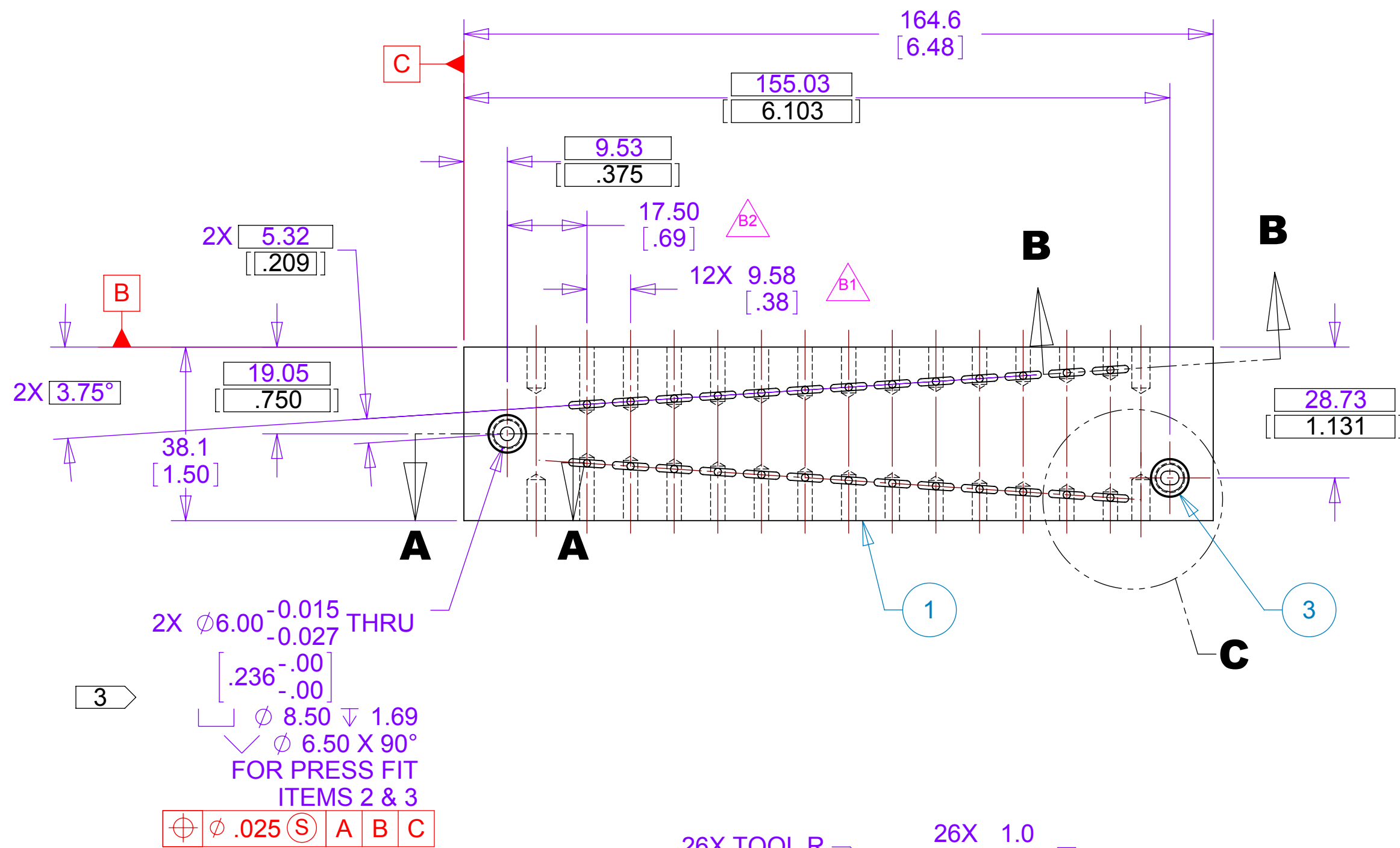
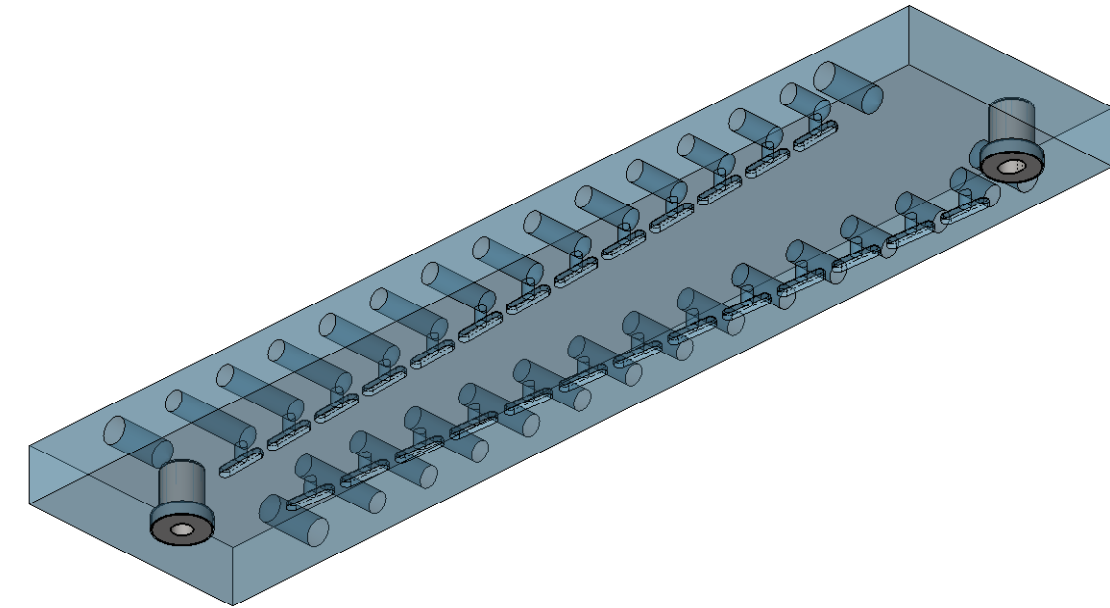
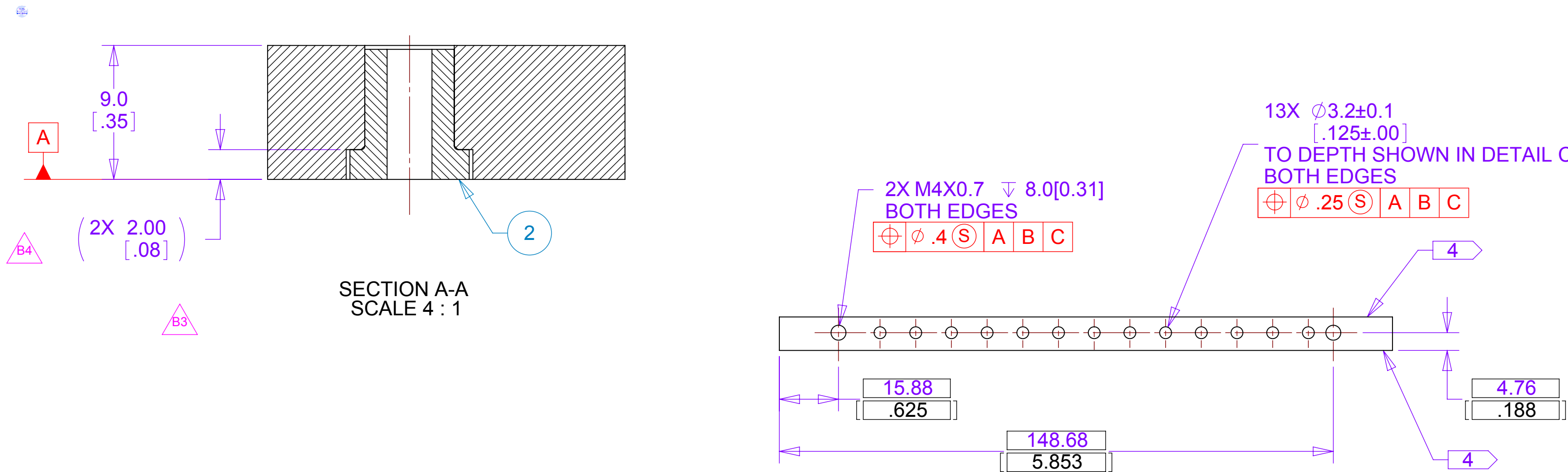

NOTES: UNLESS OTHERWISE SPECIFIED

- ALL DIMENSIONS IN MILLIMETERS [DUAL DIMENSIONS IN INCHES]
- DIMENSIONS AND TOLERANCING PER ASME Y14.5M-1994
- INSPECT AND RECORD LOCATION.
- SURFACE TO REMAIN CLEAR. DO NOT MACHINE OR OTHERWISE MAR.

THIS DOCUMENT CONTAINS INFORMATION THAT IS THE PROPRIETARY PROPERTY OF HYTEC, INC. REPRODUCTION, DISCLOSURE, OR RELEASE TO OTHERS, MANUALLY OR ELECTRONICALLY, IS STRICTLY PROHIBITED WITHOUT THE PRIOR WRITTEN CONSENT OF HYTEC, INC.

HYTEC
RELEASED
DOCUMENT

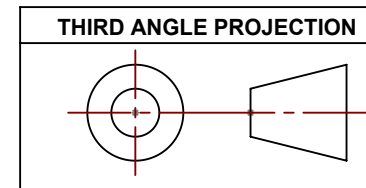

PARTS LIST				
ITEM NO.	QTY.	PART NUMBER	DESCRIPTION	MATERIAL
1	1		Chip Transfer Plate	Clear Acrylic
2	1	111-PHX-02-5206-1	Locating Pin Hole Bushing	Brass
3	1	111-PHX-02-5206-3	Locating Pin Slotted Bushing	Brass

UNLESS OTHERWISE SPECIFIED: DIMENSIONS ARE IN MILLIMETERS -TOLERANCES-		CAD GENERATED DRAWING. DO NOT MANUALLY UPDATE DO NOT SCALE DRAWING		<div>HYTEC, INC</div> <div>TITLE</div> <div>PHENIX CENTRAL UPGRADE FVTX DETECTOR ASSEMBLY JIG CHIP TRANSFER PLATE ASSEMBLY</div>			
DECIMALS X = +/- .5 .X = +/- .1 .XX = +/- .01 .XXX = +/- .001		ANGULAR = +/- .30° SURFACE FINISH = 250		DWG. NO.	SIZE		
FINISH		PART NO.				111-PHX-01-5203	D
		Designer	SIGNATURE	DATE	1 of 1		
		Drawn	Roger L. Smith	9/16/2008			
		Checked	RJ Ponchione	9/16/2008			
		Engineer	RJ Ponchione	9/16/2008			
111-PHX-01-5203-1		Approved	RJ Ponchione	9/16/2008	SCALE 1:1	REVISION B	